

INTRIX®

One Tap

Command Centre Unit

Command Centre Unit User Manual

Please read this manual before use

Product Code : 622TA99XX

Model : IBWU 3 - 2.0TL

INTRIX ONE TAP SERIES

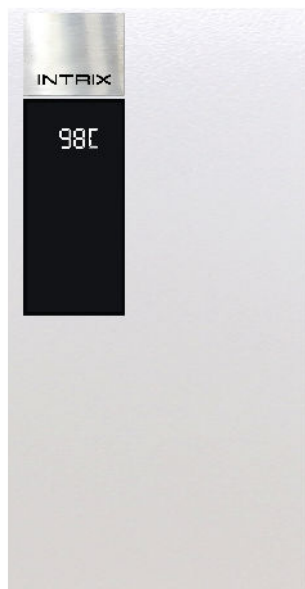

TABLE OF CONTENTS

Introduction	Pg 1
User	Pg 1
Installation & After-Sales Service	Pg 1 - 2
Contents of the Pack	Pg 2
Product Specifications	Pg 2 - 3
Installation Requirements	Pg 3
Start Here	Pg 4 - 5
How to Use	Pg 5 - 8
Cleaning & Maintenance	Pg 9
Troubleshooting	Pg 10
Notes	Pg 11

Introduction:

Congratulations on your purchase, and welcome! For after-sales and service care, please complete the enclosed warranty card and return it to us.

We hope you enjoy using your INTRIX One Tap.



Read this user manual carefully before using the appliance, and save it for future reference.

Do not switch on power when the tank is empty.

Do not switch on power before or during flushing.

Flush the unit for 5 minutes before switching on the power.

Never immerse the appliance in water or any other liquid, nor rinse it under the tap.

User

1. The INTRIX One Tap (also known as Hot Tap or Boiling Water Unit) can be used by children from 8 years and above.
2. This appliance is not intended for use by persons (including children) with reduced physical, sensory, or mental capabilities, or lack of experience and knowledge.
3. Children must not play with the appliance.
4. Cleaning and user maintenance shall not be carried out by children without supervision.
5. Keep the plug out of reach of small children.
6. The INTRIX One Tap (also known as Hot Tap or Boiling Water Unit) is suitable for household domestic use and light commercial use such as: staff kitchen areas in shops, offices and working environments; farmhouses; or for use by visitors in hotels, motels, bed & breakfasts, and other residential accommodations.
7. This appliance has a warning of potential injury from misuse.

Installation & After Sales Service

1. Check if the voltage indicated on the appliance corresponds to the local mains voltage before you connect the appliance.
2. A standard, earth (grounded) electrical outlet is required under the sink for the tap's electrical power.
3. The appliance is not recommended to be placed outdoor or in damp areas. It should be kept away from areas subject to flammable vapours, such as paint, solvent, or petrol.
4. Installation of the INTRIX One Tap (also known as Hot Tap or Boiling Water Unit) must be carried out by authorised personnel of the manufacturer. The manufacturer will not be held liable for damages caused by incorrect installation and/or failure to comply with the instructions contained in this user manual.
5. Do not use the appliance if the plug, the mains cord, the supply hose, or the appliance itself shows visible damage, or if the appliance has been dropped or leaks.
6. Always contact our After-Sales Service for examination or repair. Do not attempt to repair the appliance yourself or by any unauthorised service agent; otherwise, the warranty will become invalid.
7. If the mains cord or supply hose is damaged, you must have it replaced by the manufacturer to avoid a hazard.
8. The use of accessory attachments other than those recommended by the manufacturer may cause safety hazards.



The appliance is equipped with a thermal fuse. Always ensure that the water tank is filled before connecting the power cord. If the tank is empty and the power status is ON, the thermal fuse in the heater control will disconnect the current to the heater after approximately one minute in order to protect the heater from a “dry start” failure. Continued misuse will cause damage to the appliance and will invalidate the warranty.

Content of the Pack

1. INTRIX One Tap (also known as Hot Tap/ Boiling Water Unit)
2. Tap Assembly

What you need to get started

1. Ruler or Measuring Tape
2. Pliers
3. Hand or Electric Drill
4. Small Drill Bit for starter holes
5. 35mm Drill Bit (if no sink hole available)
6. Gloves
7. Safety Glasses
8. Open-end Wrench
9. Tubing Cutter
10. Bucket



Tap Compatibility: Tap supplied is vented and designed to operate safely with the INTRIX One Tap (also known as Hot Tap or Boiling Water Unit). Do not attempt to change the tap as this will prevent the safe release of expansion. Fitting a closed-vent tap will void the warranty and may result in damage to the appliance and the property.

For safety reasons, this unit is designed with lower pressure to prevent splashing and spitting of water. Therefore, a slight delay in water flow after the tap has been turned on is normal. This also indicates that the priming chamber is functioning properly.

Product Specification

Model	: IBWU 3-2.0TL
Voltage (V)	: 220-240
Power (W)	: 1700-2000
Dimension (mm)	: W 190 x H 360 x D 340
MAX. Pressure (Mpa/ bar)	: 0.4/ 4.0
MIN. Pressure (Mpa/ bar)	: 0.15/ 1.5
Capacity (L)	: 2.6
Water Output	: Ambient and Hot
Temperature Range	: 60°C to 98°C

IMPORTANT

If the incoming water pressure is above 4.0 bar, a pressure limiter is required.

Wiring Diagram

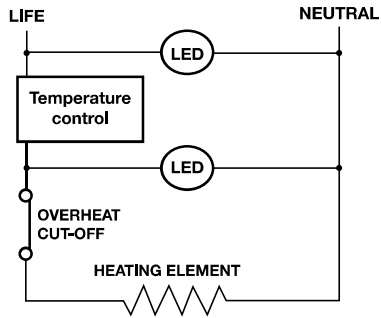

Installation Requirements

1. Make sure that you have all the necessary parts and tools as described on Pg 2.
2. Identify an ideal location to mount your tap. This can be an existing sink hole in the sink top, or you may drill another hole with maximum diameter of 35mm into the sink or work surface.

IMPORTANT

When you identify the ideal location to place the tap, also consider the utensils you will use with the appliance, such as height of the water tumbler, cooking pot, etc.

Location of the hole should also provide easy access for tank connections.

3. For drilling on **Stainless Steel sink**: The thickness of the sink must not exceed 70mm. You will need a 35 mm knockout punch, which is available at most specialist stores. Alternatively, you may drill the hole with an expandable drill.
4. For drilling on **Porcelain worktop**: Proper tools are required to drill through a porcelain or cast iron sink. If you are not familiar with this process, kindly consider to engage a professional plumber as you may severely damage the sink without the special tools.
5. Before connecting to the power supply, the INTRIX One Tap (also known to Hot Tap or Boiling Water Unit) must be filled with water.
6. Do not use an extension cord with this appliance. Appliance must be within 1 meter distance from the power supply.
7. Use of pipe sealing compounds is not recommended as it may cause unpleasant taste and odour to the water.

IMPORTANT

The INTRIX One Tap (also known to Hot Tap or Boiling Water Unit) must be installed in accordance with the relevant requirements of the appropriate building regulations by application of The Building Regulations and the Water Supply (Water Fittings) Regulations.

In territories other than those listed above, the local regulations in force must be complied with.

National Wiring rules may contain restrictions concerning the installation of these units.

Plumbing connections must comply with all regulations.

START HERE

1. Mounting the tank

Place the tank vertically beneath the tap.

Make sure that the silicon tube from the tap reaches the centre tap supply of the tank. Make sure tubes connecting to the tap is not twisted or kinked.

Do not connect to power supply during installation.

Use ONLY Open-vent Tap that is compatible with the appliance.

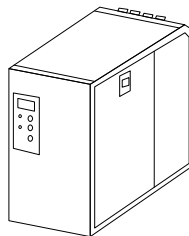

2. Installing the tap

Please refer enclosed **User Manual Boiling Water Tap**.

3. Connecting the tap to tank

Connect all the 1/4" plastic tubes to the rear side of the INTRIX One Tap (also known as Hot Tap or Boiling Water Unit) with the quick-connect fittings provided. Push both ends of the plastic tubes into the quick-connect fittings.

Connect the silicone tube to the side metal outlet located at the rear side of the appliance. Use the mounting clip provided to tighten the connection. It will create a secure connection if installed properly.

Make sure the tubes connecting to the tap are not twisted or kinked. Tubes can be shortened if necessary.



Tap must be open-vented type.

4. Connecting ambient water supply

1. Cold water is supplied to the tank through the tap. Connect the Tap-Out outlet to the tap using the 1/4" plastic tube and the quick-connect fitting provided.
2. It is suggested that a shut-off valve to be installed between Mains-In outlet and the cold water supply to ease future maintenance. If gate valve is used instead of shut-off valve, kindly follow the manufacturer's installation guide.
3. It is suggested that a check valve to be installed before Main-In outlet to prevent water back flow. Connecting to hot water supply is not recommended.
4. If boiling water flow too fast, it is suggested that a quick connect ball valve to be installed between Tap In outlet and the tap to control/reduce the flow speed.

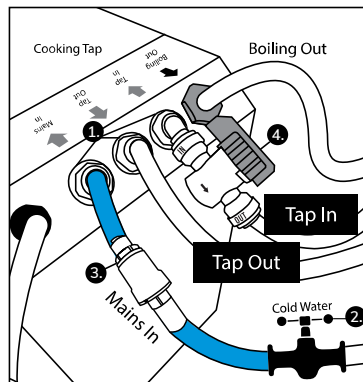



DO NOT lengthen the tubes, as this would impair the performance of the INTRIX One Tap (also known as Hot Tap or Boiling Water Unit) and invalidate the warranty.

Shorten the pipework to the minimum.

Make sure the tubes connecting to the tap are not twisted or kinked.

Water pressure to the tank MUST NOT fall below 1.5 bar.

5. Check for leaks

Turn on the shut-off valve.

Turn on the hot tap (push to unlock)

Water will start filling up the tank. When the tank is full (about 1 minute), water will start flowing from the hot tap.

Turn off the tap and check for any leaks.

IMPORTANT

DO NOT switch on the appliance for the entire checking process.

6. Prepare for power

The electrical thermostat and control panel only control the water temperature, but not the strength of the water flow.



DO NOT switch on power when the tank is empty.

HOW TO USE

Operating Panel

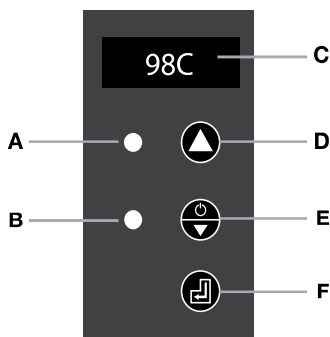

A. POWER INDICATOR LIGHT

B. INDICATOR LIGHT

- | | |
|--------------|-------------------------------|
| No Light | - Heating up |
| Yellow Light | - Heated up.
Ready for use |

C. DISPLAY PANEL

- Temperature, (E.g. 98°C)
- Clock, (E.g. 08:00)
- Filter Remaining Day, (E.g. 365d)

D. UP

E. POWER ON/ BOOST/ DOWN

F. POWER OFF/ ENTER

Setting

Turn on the right lever (cold water), flush the unit for 10 minutes before use.

Make sure the tank is filled with water before switching on the power supply.

Press and hold the POWER ON button for 5 seconds to turn on the power.

Press ENTER and use the UP and DOWN function to scroll the menu:

- a. CLOC Mode - Clock Function
- b. SP Mode - Temperature Setting
- c. ONt Mode - ON timer*
- d. OFFt Mode - OFF timer*
- e. Continuous Mode - Always switch on*
- f. Boost Mode - Boost*
- g. Power Off

a. CLOC Mode: Clock Function

CLOC Mode allows user to set the actual local time.

Press ENTER Press Up & Down Select CLOC Mode Press ENTER Press Up & Down



Select
actual time

Press ENTER
again

Setting being
save

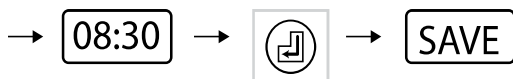

b. SP Mode: Temperature Setting

SP Mode allows the user to adjust the boiling water temperature.

Press ENTER Press Up & Down Select SP Mode Press ENTER Press Up & Down

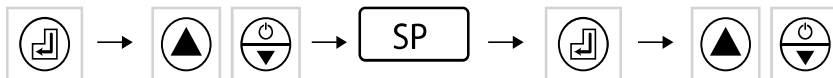

Select preferred
temperature

Press ENTER
again

Setting being
save



Indicator light
turns yellow
when ready
for use.



IMPORTANT

Temperature setting ranges from 60°C to 98°C.

The lowest temperature of 60°C is required to prevent the growth of Legionella bacteria.

When the water temperature drops by 5°C below the set temperature, this will trigger the heater to be activated, and start re-boiling the water.

The appliance does not boil the water in the tank continuously.

c. ONt Mode: ON Timer*

ONt Mode allows the user to pre-set the appliance to be switched on at specific time.

Press ENTER Press Up & Down Select ONt Mode Press ENTER Press Up & Down

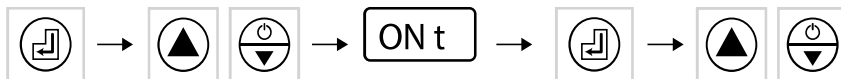

Select
preferred time

Press ENTER
again

Setting being
save

Display panel
shows temperature

**d. OFFt Mode: OFF Timer***

OFFt Mode allows the user to pre-set the appliance to be switched off at specific time.

Press ENTER Press Up & Down Select OFFt Mode Press ENTER Press Up & Down



Select
preferred time

Press ENTER
again

Setting being
save

Display panel
shows
temperature

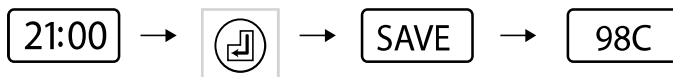

ECO

When it reaches the preferred time for OFFt Mode (21:00 in the example), the display panel will display SLP that indicates SLEEP Mode.

e. Continuous Mode: Always Switch On*

In Continuous Mode, the appliance will remain switched on at all times. Sleep Mode needs to be de-activated.

Set ONt and OFFt mode with the same timing.

Example:

Ont at 06:00

OFFt at 06:00

With this, the appliance will be switched on all the time without stop.

For setting of ONt Mode and OFFt Mode, please refer section (c) and (d).

f. BOOST Mode - Boost*

BOOST Mode is intended for an immediate heat-up while the appliance is in “sleep”.

This function lasts for 10 minutes only and will return to OFFt Mode after that.

Display panel
shows SLP in
SLEEP Mode

Press down
and hold for
5sec

Display panel
shows
temperature



g. Power Off

Press and hold ENTER button for 5sec to switch off the appliance.

Press and
hold ENTER
for 5sec



Display panel
will be switched
off (Light off).
Only power
indicator light is
switched on.



IMPORTANT

DO NOT use wall switch to switch ON/ OFF the appliance.

If you notice vapour or a boiling noise, lower the temperature setting (Refer Pg. 6, SP Mode setting).

Due to heat transferred from the heater, you will get lightly warm water output at ambient setting and this is normal.

Occasional drippings from the water tap is normal.

CLEANING & MAINTENANCE

Seasonal Drainage

To prevent damage when appliance is exposed to freezing temperature, water in the tank must be drained out.

1. Press and hold the ENTER button for 5 seconds to switch off the power.
2. Switch off the wall switch.
3. Unplug the power supply.
4. Turn on the tap. Let it run until the water is cold.
5. Place a 3-litre container under the drain plug at the back of the appliance. Use a screwdriver to remove the screws and O-ring at the opening of drain tube.
6. When the water tank is fully drained, reconnect the screws and O-ring. Tighten to reseal the drain.

IMPORTANT

When the appliance is not used for extended period of time, it is advisable to do a drain-out exercise to refresh the quality of the water.

Bacteria might have grown in the water when it is left unused for long, hence it is not suitable for consumption. After drainage, flush the water tap for 10min before use.

Cleaning

Clean the casing, tapware, external filter, piping, and all other fittings with a soft cloth, mild soap, and water.

DO NOT use strong, corrosive spray or abrasive cleaners/ chemicals.

DO NOT pour water over the appliance.

Replacement Filter

The INTRIX One Tap (also known as Hot Tap or Boiling Water Unit) will alert the user when filter replacement is required.

When you hear a beeping sound or see the LED panel blinking, you are recommended to change the filter.

To change the filter:

Press ANY button to disable the blinking and buzzer sound.

1. Open the side door.
2. Grip the filter, rotate it clockwise, and gently pull down.
3. Insert the new replacement filter to the holder. Turn the filter anti-clockwise until the filter comes to complete stop and lock into position.
4. Close the door.



The beeper will sound for 3 days if the filter is not replaced, repeating every 6 months of usage.

If the replacement filter is not changed in due course, it will deteriorate the performance of the appliance that causing the warranty to be void.

You may also need to replace the filter if you notice unpleasant odours or tastes.

FILTER PERFORMANCE DATA SHEET

	SERVICE CYCLE	FLOW RATE	CLAIM
NSF/ANSI 42	7925 Gallons	1.5 GPM	Chlorine Reduction Nominal Particulate Reduction, Class I Bacteriostatic Effects
NSF/ANSI 53	7925 Gallons	1.5 GPM	Cyst Reduction Turbidity Reduction
NSF/ANSI 401	7925 Gallons	1.5 GPM	Microplastics Reduction

TROUBLESHOOTING

PROBLEM	POSSIBLE CAUSE	WHAT TO DO
Water is not hot	<ol style="list-style-type: none"> 1. There is a connection problem. 2. The electric outlet is impaired. 3. You have not switched on the appliance. 	<ol style="list-style-type: none"> 1. Check if the appliance is plugged in. 2. Make sure the appliance is connected to a properly earthed (grounded) electric outlet. 3. Press the ON button to switch on the appliance.
Hot water drips or splutters from tap	<ol style="list-style-type: none"> 1. Tube connecting the tap and the dispenser tank is clogged, twisted or kinked. 2. Incorrect connection of the 1/4" plastic tube, e.g. cross-connected. 3. Valve is damaged. 	<ol style="list-style-type: none"> 1. Make sure the tubes connecting the tap and the dispenser tank is not clogged, twisted or kinked. 2. Make sure the 1/4" plastic tubes connecting the tap to the dispenser tank, and the tap to water line are installed correctly. 3. Replace the valve.
Water does not flow right away or at all	<ol style="list-style-type: none"> 1. Valve on the water supply is closed. 2. Tubes are twisted or bent. 3. The tap is clogged. 4. Filter is clogged. <p>Note: The appliance is with low pressure design. Hence, a slight delay in water flow is normal.</p>	<ol style="list-style-type: none"> 1. Make sure all valves on water supply are open. 2. Untwist the tubes that connecting the tap and the water dispenser. 3. Descale the tap. Open the spout and remove any particles clogging the outlet. 4. Change the filter. Contact our Service Hotline.
Water boils vigorously or vapour appears	<ol style="list-style-type: none"> 1. Temperature is too high. 	<ol style="list-style-type: none"> 1. Lower the temperature. 2. If the problem persists even after lowering the temperature, switch off and unplug the appliance. Contact our Service Hotline.

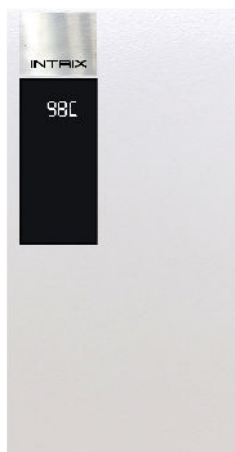

Scan Here
for User Manual